



Installation Guide – TEOS Lite devices

Description

This procedure should be used with Lite for TEOS devices

This procedure is used for all the **preconfigured “/TM” (for Manage for TEOS) BRAVIA** with a **focus on Lite usage** and for the tablet and players installation

Requirements

- A set of USB keys formatted in **FAT32**
- A USB key formatted in **FAT32** with on the **root** folder *.apk files:
 1. TEOS Lite Player.apk which can be found on google play or [HERE](#)
 2. For Players and Tablets TEOS Control app from 1.49 [HERE](#)
- Please refer to <https://teos.solutions/> to find all the details, apps, setup if needed (under resources)

Table of Contents

1. Compatible models	4
2. BRAVIA Setup for TEOS Lite	5
2.1 Understanding of the Pro Mode access.....	5
2.2 Configuration for TEOS Usage.....	6
2.3 Configurations under BRAVIA Settings.	6
2.4 Under settings enable developer options and ADB.	6
2.5 Enable IP Control under settings.....	7
2.6 Installation of apks.	8
2.7 Privacy permissions to TEOS Apps.....	9
2.8 Go to pro settings to allow TEOS Apps & Configure your BRAVIA.....	10
3. Tablet configuration for TEOS Lite	12
4. Player configuration for TEOS Lite	13

1. Compatible models

Make sure the language setup of your device is in English: go to *Settings* and choose **English**. You must be in normal or pro settings mode to be able to do the update. Check in what mode you are. For first installation, the device is in normal mode

Check your version of Android, if you are **already in Android 10, make sure you are using the latest available version for all the BRAVIAs**.

Recommended model names are:

- FW-32BZ30J
- FW-100BZ40J
- FW-43BZ35J
- FW-50BZ35J
- FW-43BZ30J
- FW-50BZ30J
- FW-55BZ30J
- FW-65BZ30J
- FW-75BZ30J

Compatible models names when Android 10 will be available:

- FW-55BZ40H/1
- FW-65BZ40H/1
- FW-75BZ40H/1
- FW-85BZ40H/1

Compatible tablets (Android 8.1 minimum):

- TEB-10XPLN
- TEB-10SLBN

Compatible player:

- AAV-X96 : <https://aavhardware.com/shop/players/aav-x96-max-signage-player/>

2. BRAVIA Setup for TEOS Lite

2.1 Understanding of the Pro Mode access

In [Pro mode], you can use various convenient functions for professional use. Here, we introduce how to change to [Pro mode] and typical functions of [Pro mode].

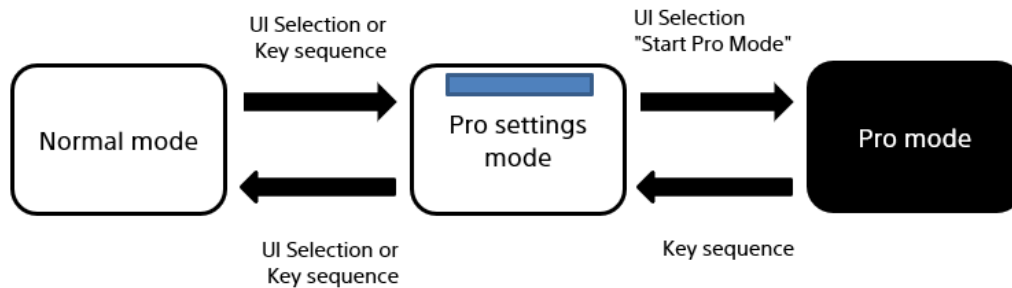

Normal mode: This is the default mode. [Pro mode] functions are not available in this mode.

Pro settings mode: This mode allows you to set various settings of [Pro mode] functions.

Pro mode: This is the professional use where you can use the [Pro mode] functions.

After each switch in each mode, the monitor will reboot.

Key sequence (press the below keys on the remote commander in order within 3 seconds)

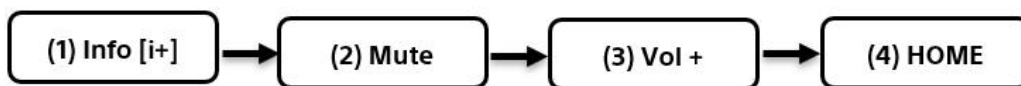

UI Selection (only for FW-XXBZ models), this option allows you to switch between the different modes using the Android UI (app view)

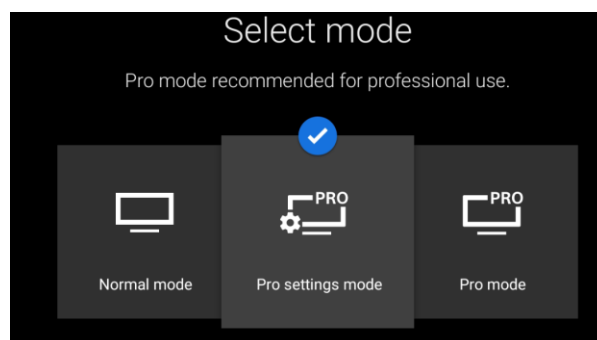

* Initially you cannot change the mode from [Pro mode tool] in [Pro mode]. If you want to change the mode from [Pro mode tool], go to [Pro settings] t [Function restrictions] t [Apps] and change [Pro mode tool] to [Enable] in [Pro settings mode].

2.2 Configuration for TEOS Usage

To start this procedure, you need to make sure your device is in pro settings and shows pro settings in process. If it is not the case, please refer to the procedure upper.

2.3 Configurations under BRAVIA Settings.

When you are in BRAVIA home menu, go to settings > system

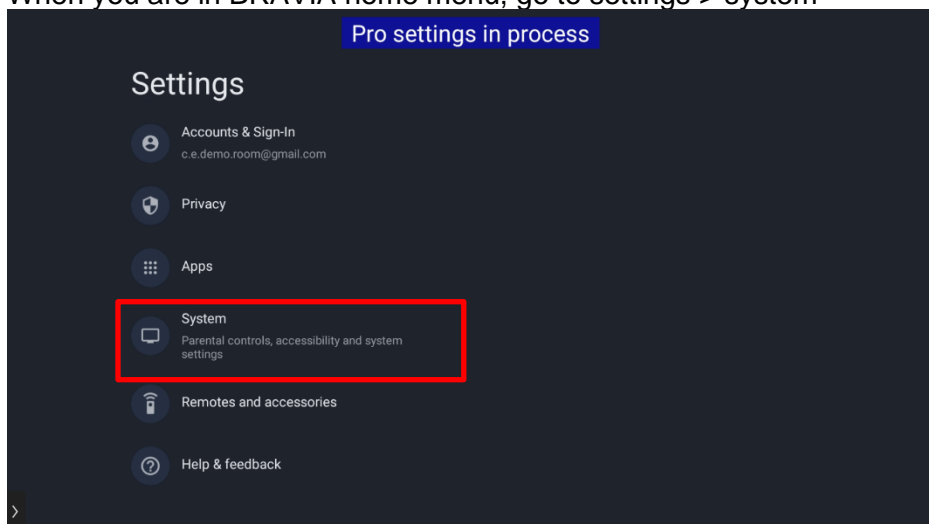

- a) Go to settings > System > Power
- set power saving, Idle TV standby, Auto shut-off to Off

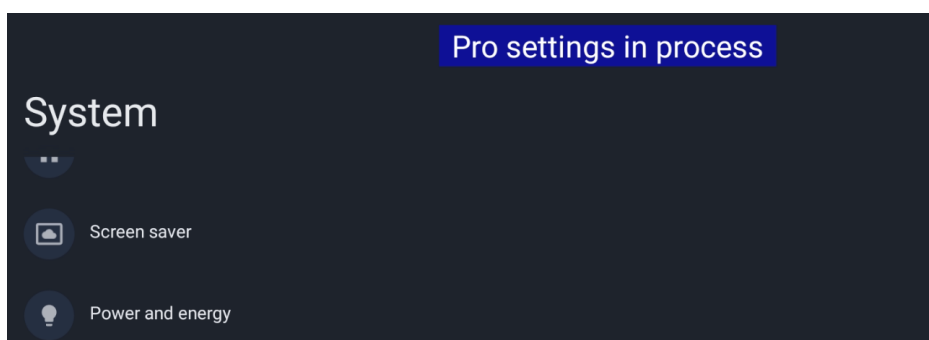

2.4 Under settings enable developer options and ADB.

- a) For that go back to Settings> System > About> Build
- Press 7 times in build option, developer mode will be unlocked

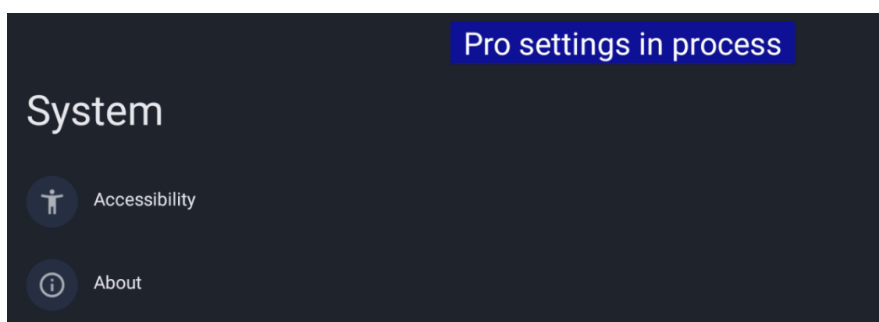

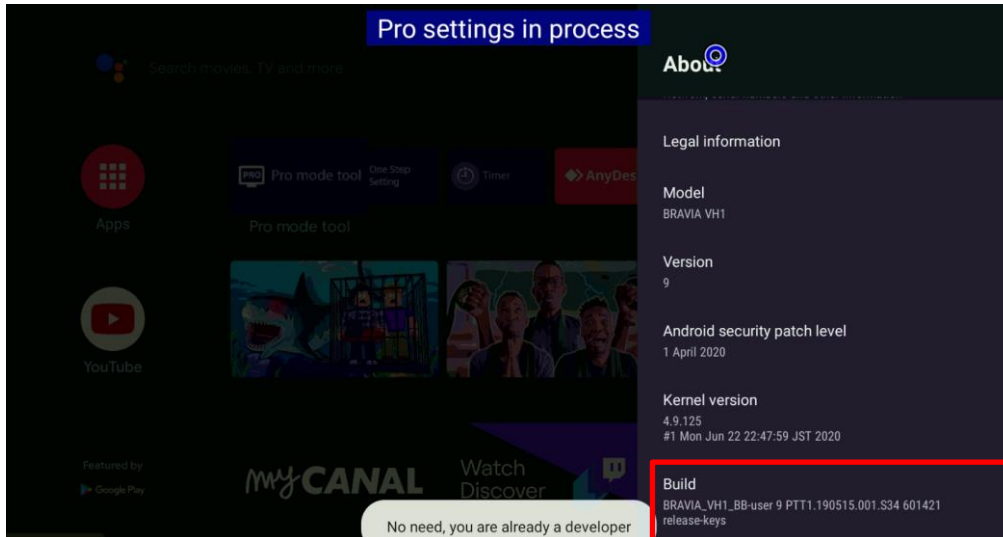

- Go to Settings > System > Developer mode and enable ADB debugging and “stay awake” option

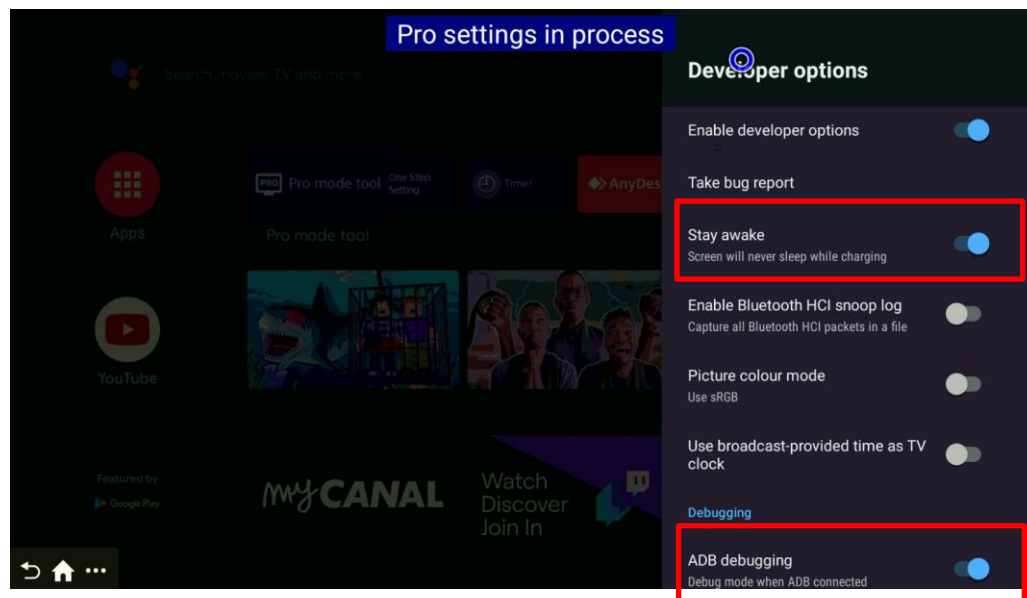

2.5 Enable IP Control under settings.

- Go to settings > Network & Internet and home network settings

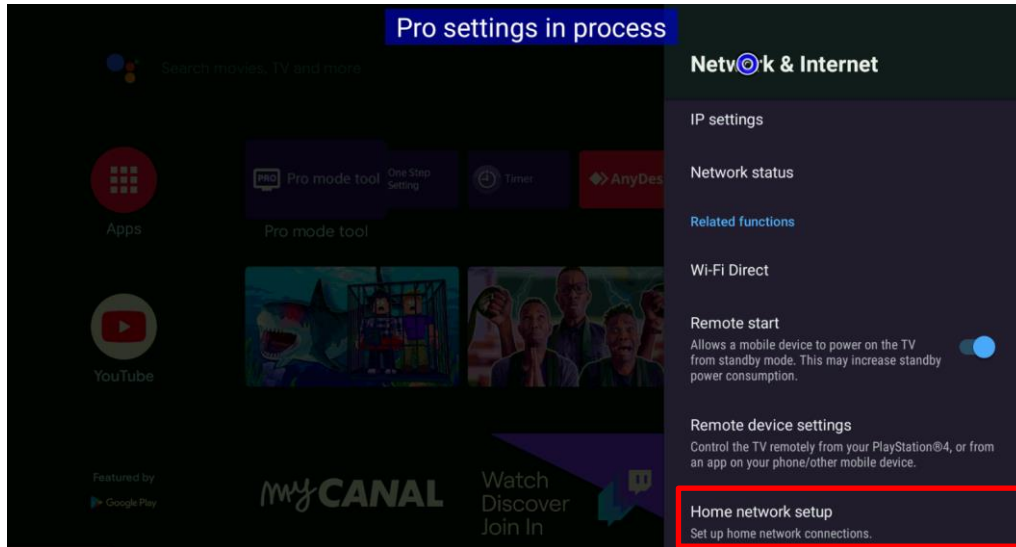

b) Go to IP Control, set the **authentication to None** and enable **Simple IP Control**

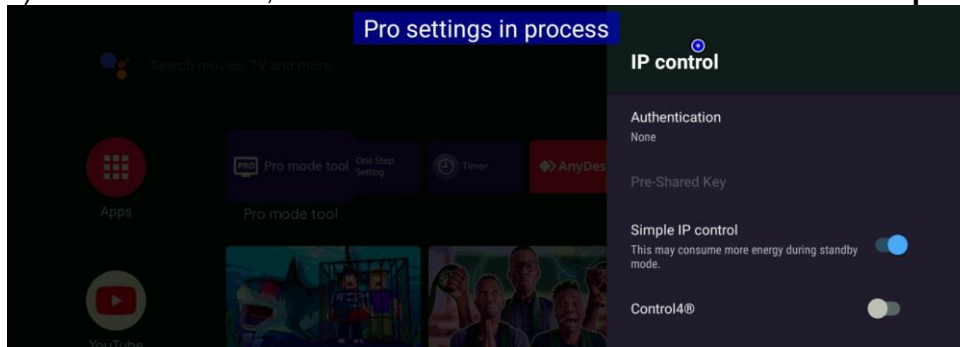

2.6 Installation of apks.

Press “Home”, go to settings and select the **first option “pro settings”**

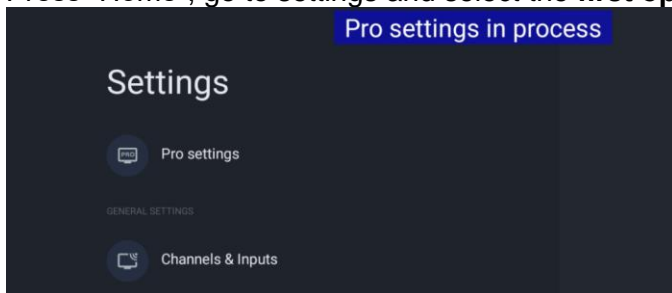

- Allow WebAppRunTime to access photos, media and files when the pop-up appears
- Insert your USB drive with the latest TEOS Lite Player apk available on it (must be in the root of your USB stick to be detected)
- “Install APK”** option in the BRAVIA pro setting menu will appear

- TEOS Lite Player.apk

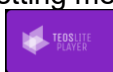

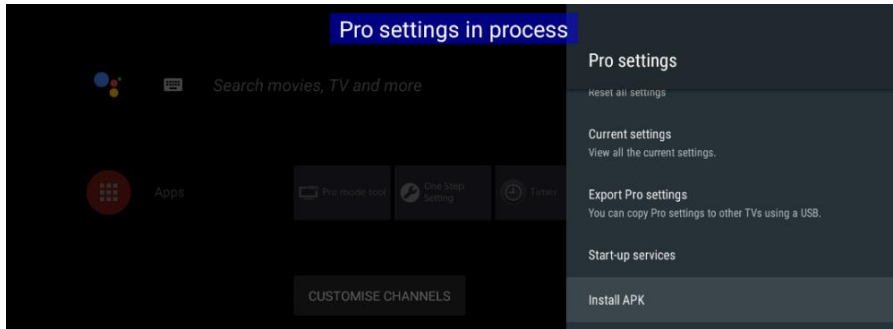

d) Select the Lite Player apk and Install

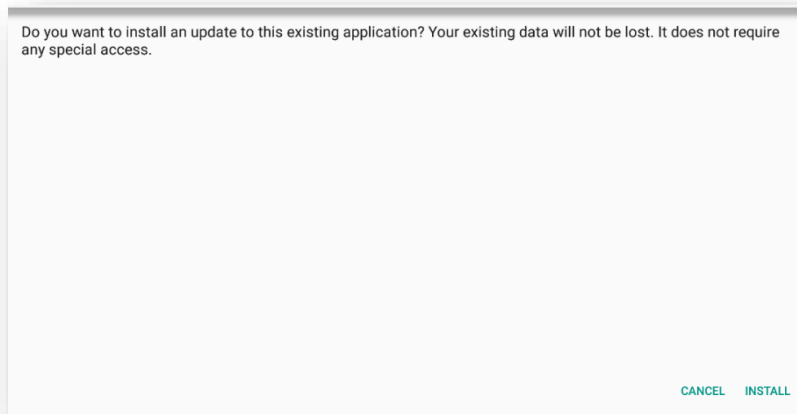

2.7 Privacy permissions to TEOS Apps.

e) Open settings > privacy > special app access > display over the apps and allow TEOS Lite Player

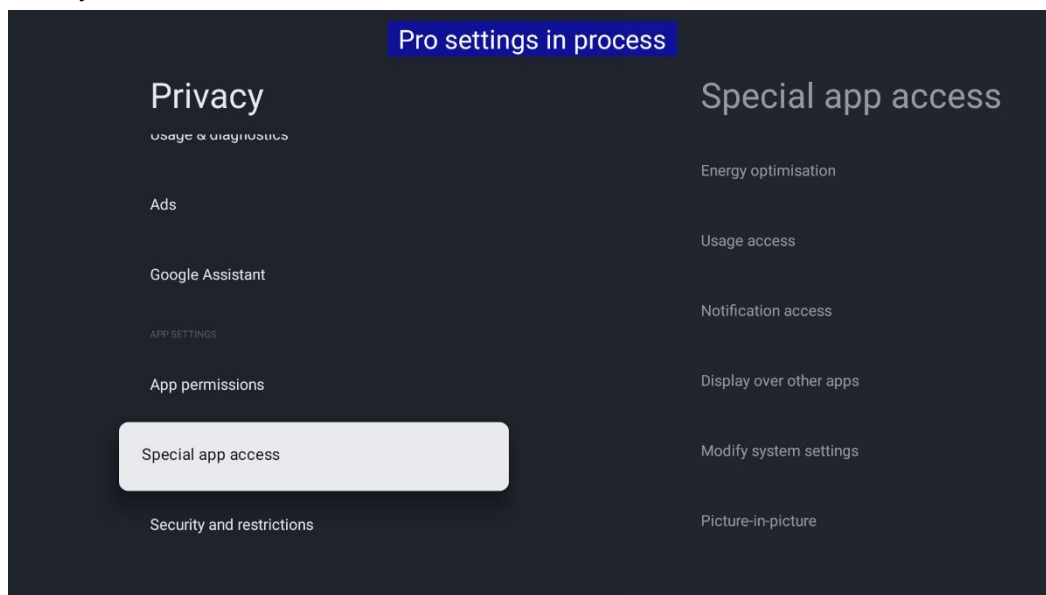

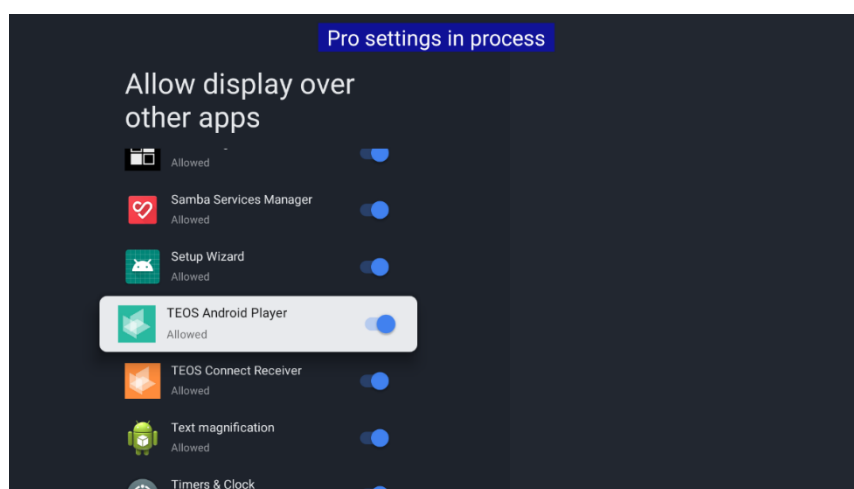
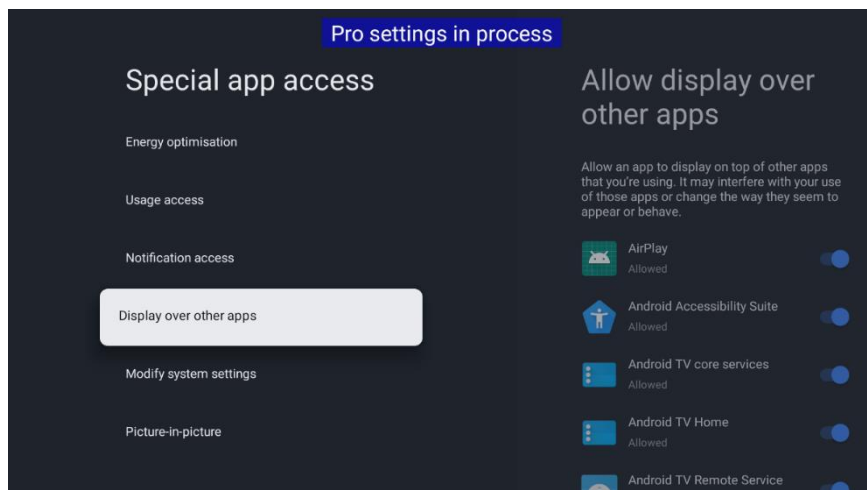

Go back to settings > apps and go to the TEOS apps. You will need for each app to give the permissions

- For TEOS Lite Player: Storage and Camera

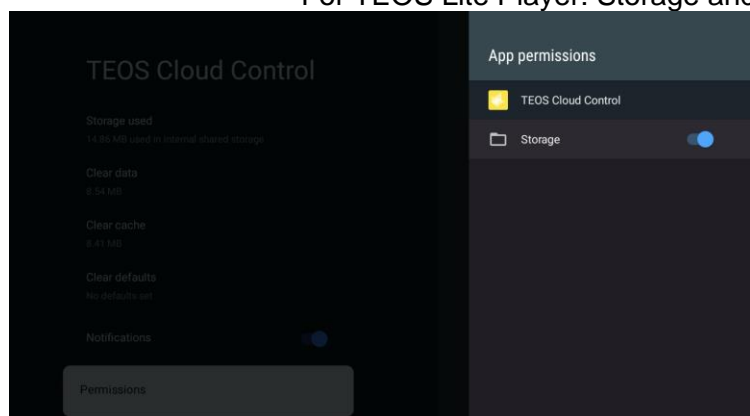

2.8 Go to pro settings to allow TEOS Apps & Configure your BRAVIA

- Go to Home Settings > Pro Settings > apps

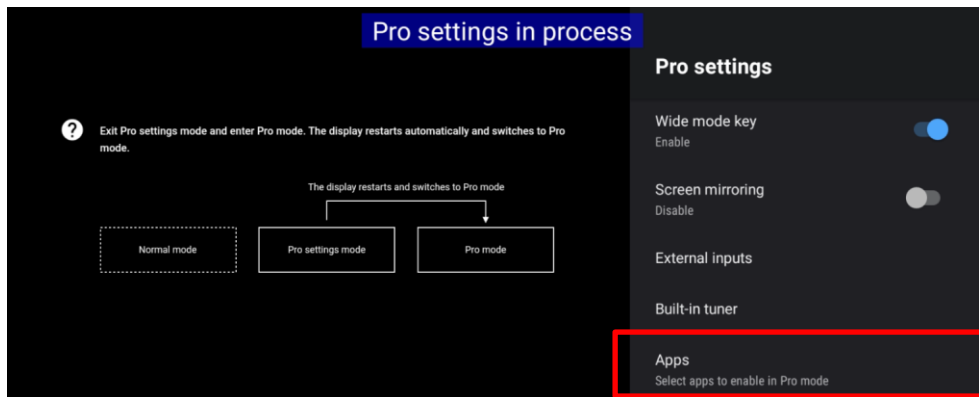

enable all the installed apps (TEOS Lite Player App)

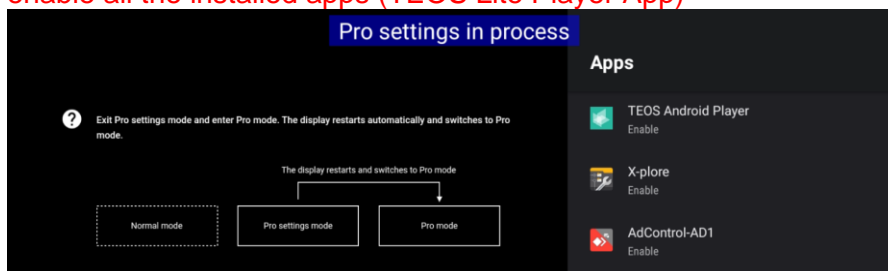

g) Go to Developer Option:

- Enable store function
- Enable Power State Control by app

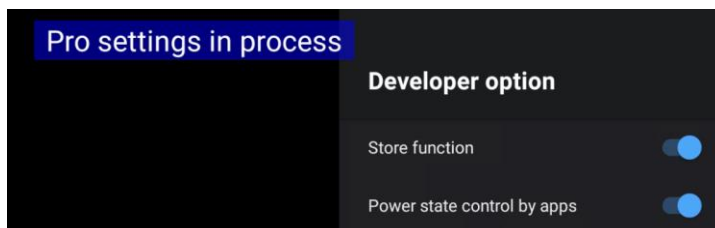

h) Go to pro settings and activate pro mode

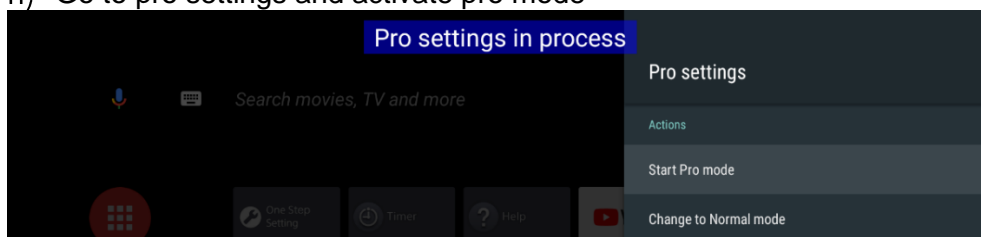

i) The BRAVIA will reboot and show TEOS Lite App waiting for configuration



3. Tablet configuration for TEOS Lite

You can install your own Android apps into the tablets. Please check the app compatibility with us to test to ensure the app is compatible with the tablet.

Go to menu > Apkinstaller

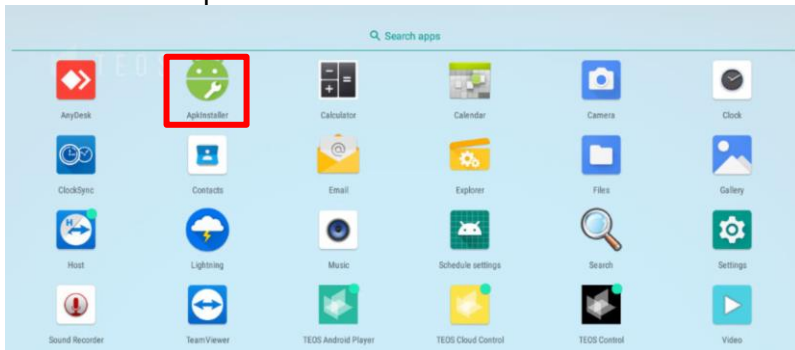

Click install and select the app you want to Install :

1. **TEOS Lite Player.apk** which can be found on google play or [HERE](#)
2. **For Players and Tablets TEOS Control app from 1.49** [HERE](#)

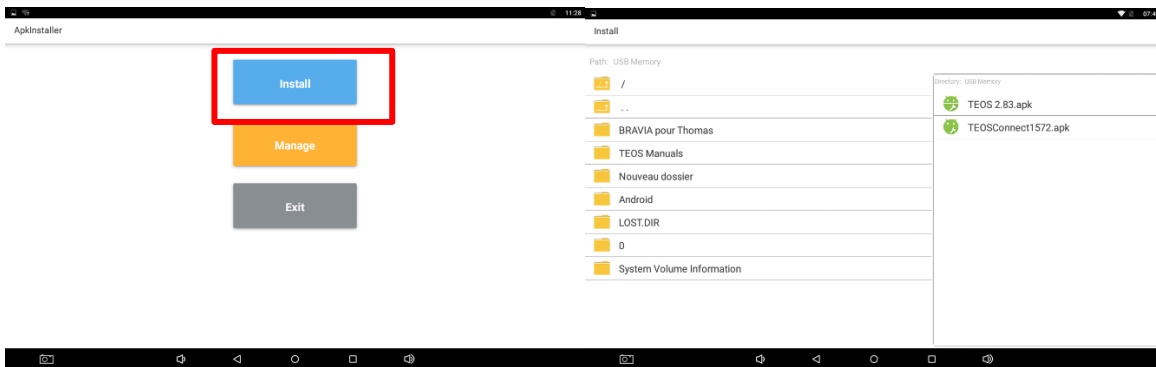

Go to home and back to the menu, open TEOS Lite Player and the app will open with QR Code and password to add it into TEOS Lite platform. Please follow the user guide for the next steps:



For more details about tablet configurations, you can download the documentation Professional Tablets for TEOS

4. Player configuration for TEOS Lite

You can install your own Android apps into the player AAV-X96.

Go to menu > Apkinstaller

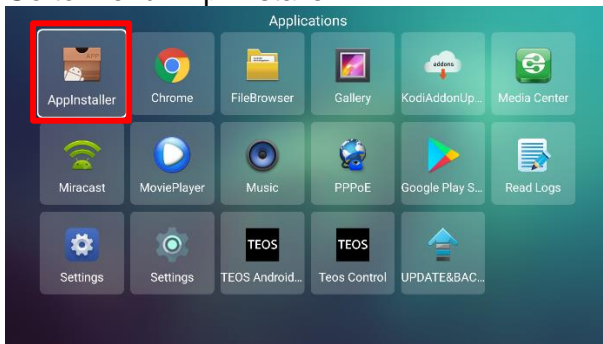

Click on the USB storage and select and select the app to install:

1. **TEOS Lite Player.apk** which can be found on google play or [HERE](#)
2. **For Players and Tablets TEOS Control app** from 1.49 [HERE](#)

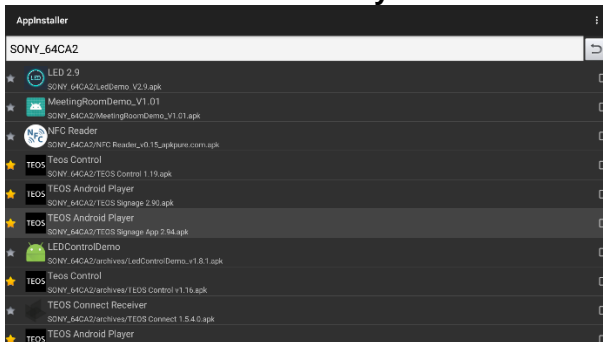

Go to home and back to the menu, open TEOS Lite Player and the app will open with QR Code and password to add it into TEOS Lite platform. Please follow the user guide for the next steps:



For more details about tablet configurations, you can download the documentation Professional Players for TEOS

Your devices are now configured for TEOS Lite usage.



Visit us on

<https://teos.solutions>